

75 × 75 × 5 × 8
(11.9kg/m)

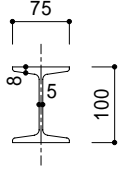

100 × 75 × 5 × 8
(12.9kg/m)

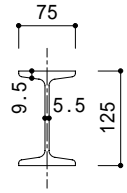

125 × 75 × 5.5 × 9.5
(16.1kg/m)

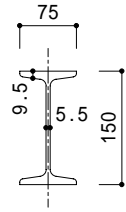

150 × 75 × 5.5 × 9.5
(17.1kg/m)

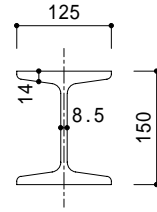

150 × 125 × 8.5 × 14
(36.2kg/m)

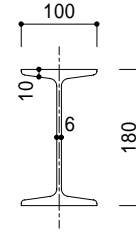

180 × 100 × 6 × 10
(23.6kg/m)

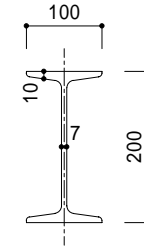

200 × 100 × 7 × 10
(26.0kg/m)

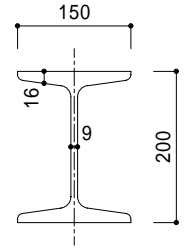

200 × 150 × 9 × 16
(50.4kg/m)

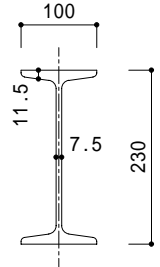

230 × 100 × 7.5 × 11.5
(30.7kg/m)

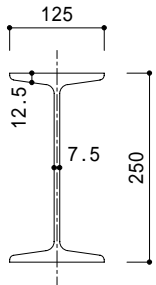

250 × 125 × 7.5 × 12.5
(38.3kg/m)

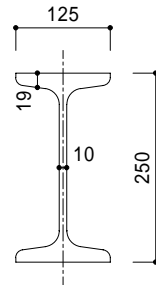

250 × 125 × 10 × 19
(55.5kg/m)

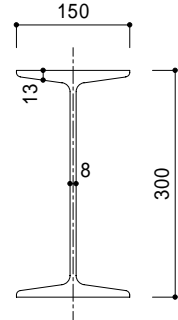

300 × 150 × 8 × 13
(48.3kg/m)

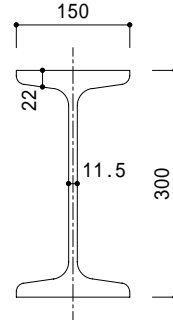

300 × 150 × 11.5 × 22
(76.8kg/m)

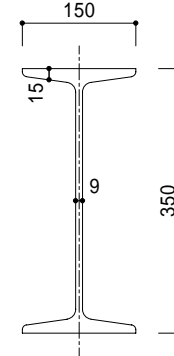

350 × 150 × 9 × 15
(58.5kg/m)

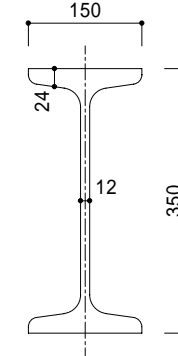

350 × 150 × 12 × 24
(87.2kg/m)

工形鋼 断面

日本標準規格 より
大正14年3月27日決定
日本工業規格(JIS)の前規格

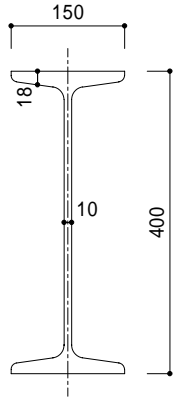

400 × 150 × 10 × 18
(72.0kg/m)

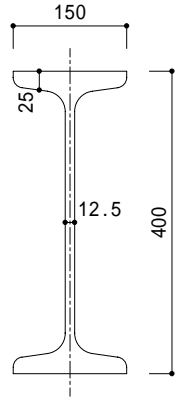

400 × 150 × 12.5 × 25
(95.8kg/m)

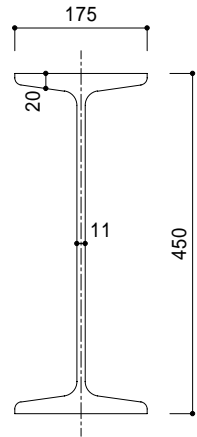

450 × 175 × 11 × 20
(91.7kg/m)

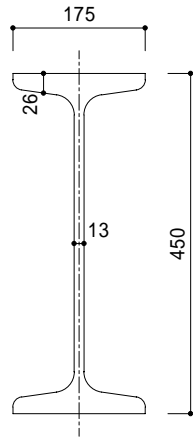

450 × 175 × 13 × 26
(115kg/m)

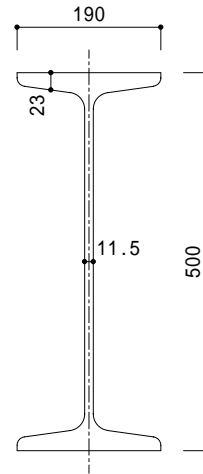

500 × 190 × 11.5 × 23
(111kg/m)

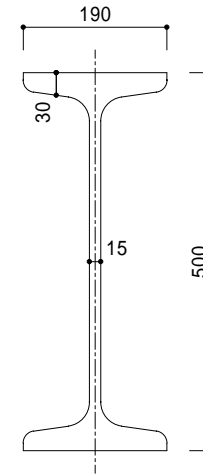

500 × 190 × 15 × 30
(145kg/m)

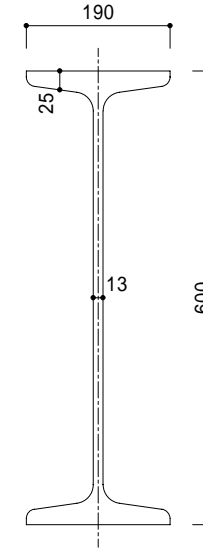

600 × 190 × 13 × 25
(133kg/m)

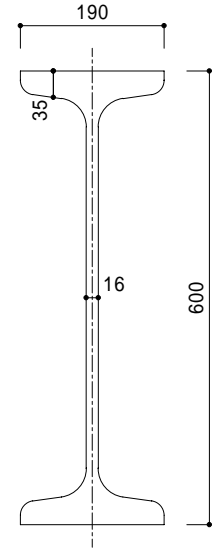

600 × 190 × 16 × 35
(176kg/m)