

B1
3" x 3"
8.50 lbs

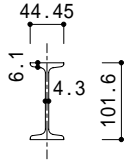

B2
4" x 1-3/4"
5.00 lbs

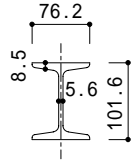

B3
4" x 3"
9.50 lbs

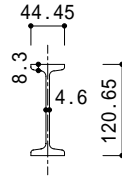

B4
4-3/4" x 1-3/4"
6.50 lbs

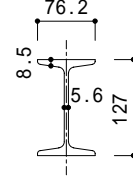

B5
5" x 3"
11.01 lbs

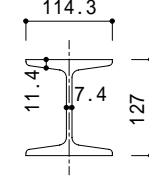

B6
5" x 4-1/2"
17.90 lbs

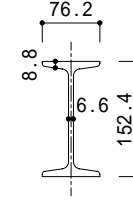

B7
6" x 3"
11.99 lbs

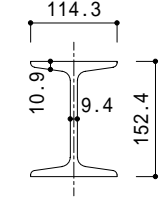

B8
6" x 4-1/2"
20.00 lbs

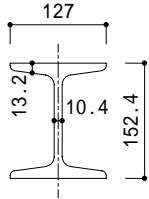

B9
6" x 5"
25.00 lbs

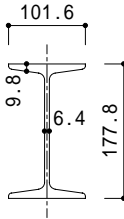

B10
7" x 4"
16.01 lbs

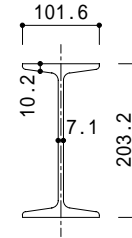

B11
8" x 4"
18.01 lbs

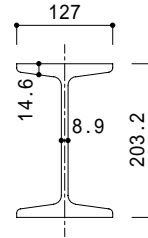

B12
8" x 5"
28.02 lbs

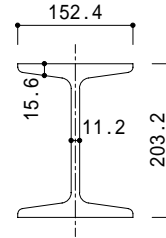

B13
8" x 6"
35.00 lbs

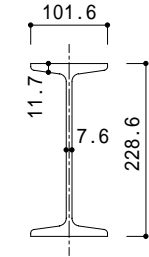

B14
9" x 4"
21.00 lbs

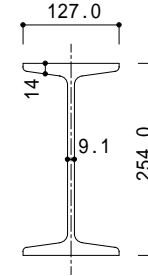

B15
10" x 5"
29.99 lbs

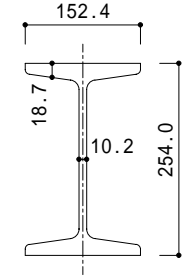

B16
10" x 6"
42.02 lbs

I 型鋼製品断面

製品目録(大正14年版)より

lbs : 1feetあたりの重量

1feet = 12inch = 304.8mm

1pound = 0.45359237kg

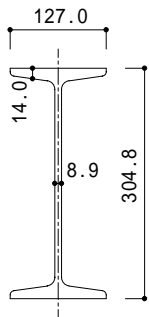

B17
12" x 5"
31.99 lbs

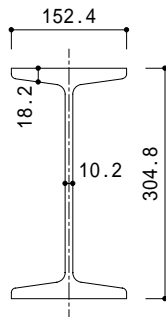

B18
12" x 6"
44.02 lbs

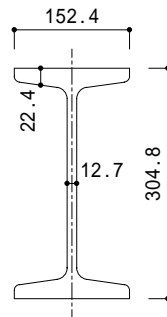

B19
12" x 6"
53.99 lbs

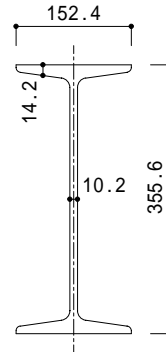

B20
14" x 6"
46.01 lbs

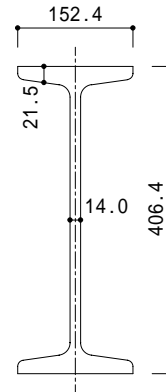

B21
16" x 6"
61.97 lbs

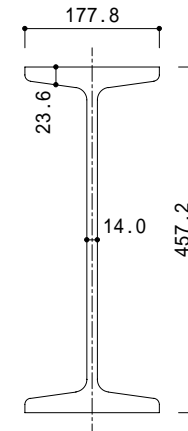

B22
18" x 7"
75.02 lbs

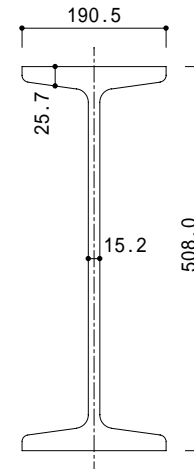

B23
20" x 7-1/2"
88.96 lbs

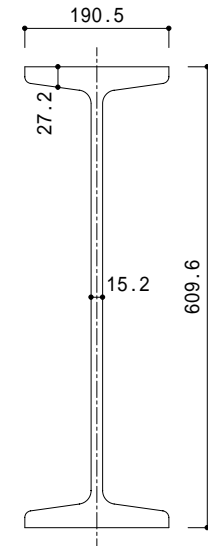

B24
24" x 7-1/2"
99.93 lbs