

E-170 Loudspeaker Enclosure Drawing

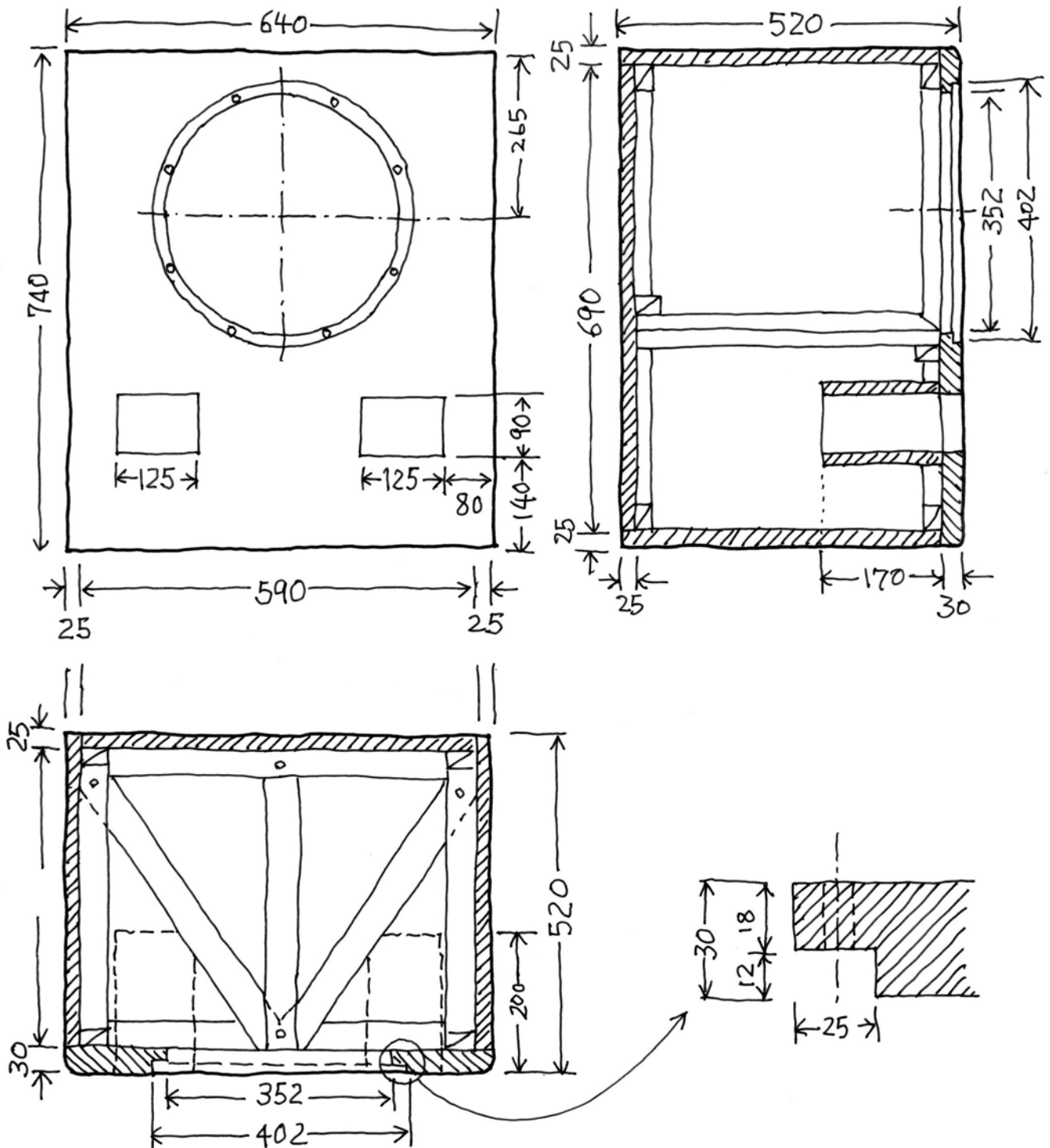

Unit : mm (Unless otherwise noted)

Wood Materials : A Cherry plywood (thickness=25mm) and a Chinese quince laminated lumber (thickness=30mm) only for front baffle

Driver : Pioneer TAD 1601a

Designed by Yuichi Arai (Refer to the December 1990 issue of MJ Magazine, Tokyo for details.)